

## 4. Maintenance

### 4.1 Opening the Device

Detach the device from the clip if you need to replace the battery, or when you would like to connect the device to your computer.

Use a paperclip or similar shaped tool to separate the device from the clip

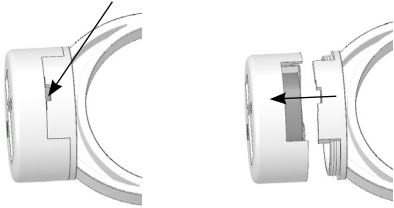

### 4.2 Replacing the Battery

Replace the battery annually or when the empty battery indicator icon is active. When removing the battery or USB power source, the device will still remember its last state, and once re-connected to a power source it will continue from the state last known before the power source was removed.

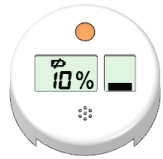

The Low Battery Indicator icon displays when it is time to replace the battery

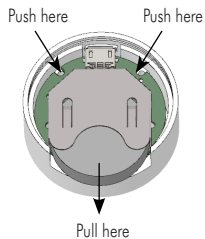

Push the battery out of the retainer with the use of a pencil shaped object

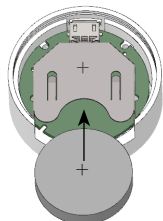

Slide the new battery into the retainer with the positive (+) side of the battery facing up

### 4.3 Cleaning

Always remove the battery and/or the USB power source before cleaning the device. Not removing the battery before cleaning the device can cause a short circuit and might destroy electronic components and voids the manufacturers warranty.

Wipe the plastic casing with a slightly damp micro fiber or other soft, lint-free cloth. Use a dry cloth or paint brush to whisk away dust from the casing.

For removing dust on the electronics you could use compressed air to blow away the dust. Never use water to clean the electronics as this may damage the electronic parts of the device and cause a short circuit.

### 4.4 Disposal



The Device or battery should not be placed in household waste bins. Please check local regulations for information about the disposal of electronic products in your area.

## Ordering Information

**Zebbron™ Gas Management Electronic Indicator**

AG6-4130 Zebbron Gas Management Electronic Indicator for LC-MS Filter, 1/pk

Reorder at [www.phenomenex.com/GasManagement](http://www.phenomenex.com/GasManagement)

IL67760419\_W\_6

**Zebbron™**  
Gas Management

## Electronic Indicator for LC-MS Filters User Guide

**REPLACE.  
REORDER.  
RELAX.**



## Compliance



## Terms and Conditions

Patent Pending: PCT/NL2012/050477

Subject to Phenomenex Standard Terms and Conditions, which may be viewed at [www.phenomenex.com/TermsAndConditions](http://www.phenomenex.com/TermsAndConditions).

Trademarks  
Zebbron is a trademark of Phenomenex.

FOR RESEARCH USE ONLY. Not for use in clinical diagnostic procedures.  
© 2019 Phenomenex, Inc. All rights reserved.

[www.phenomenex.com](http://www.phenomenex.com)

 **phenomenex®**  
...breaking with tradition™

## Overview

The Electronic Indicator is a monitoring device that alarms you when planned maintenance or replacement for a consumable is due.

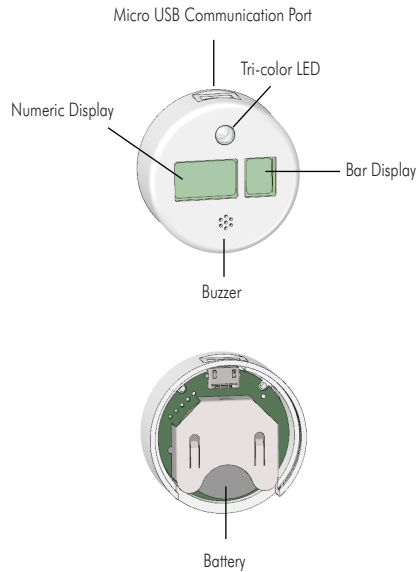

For Zebtron™ Gas filters, the following model should be used.

AG6-4130



Electronic Indicator with Clip for Universal Ring Nut

## Technical Specifications

Category	Description
Power Requirements	3V CR2450 non-rechargeable Lithium Coin Cell battery
Operating Temperature Range	0 ~ +48 (C)
Storage Temperature	-10 ~ +55 (C)
Operating Humidity	10 percent to 80 percent relative humidity, non-condensing
Storage Humidity	10 percent to 90 percent relative humidity, non-condensing
Recommended Configured Time Range	1 month ~ 3 years
Battery Lifetime	approx. 1 year (with standby setting enabled)
Communication	Micro-B USB Connector
Warranty	2 Years factory warranty from the date of purchase
Certifications	CE , FCC
Compliance	RoHS, WEEE

## Safety Information

- There are no serviceable parts in this unit. Opening the device—other than to change the battery—or tampering with the internal parts will void the factory warranty.
- Not intended for outdoor use or wet locations.
- Always obtain prior authorization from your supervisor before installing or using this device in controlled, hazardous or restricted environments.

## Battery Storage and Handling

- Do not swallow the battery. Keep this device out of reach of children. Lithium coin cells can cause serious injury or death if swallowed.
- Do not try to open the battery and do not burn the battery in fire. Exposure to the ingredients contained within or their combustion products could be harmful.
- Do not short-circuit battery. Short-circuiting the battery may cause leakage and high heat which can cause burns.
- Only remove the battery protection tab when you start using the device. When you are not using the device remove the battery and store it in a dry and secure place away from other batteries or heat sources and out of reach of children.

## 1. Quickstart

### 1.1 Enabling the Device

The battery is pre-installed into the device and disabled by a battery protection tab. To initialize (start) the device with its default settings pull the battery protection tab out.

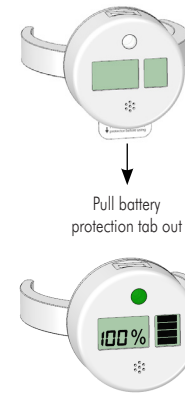

### 1.2 Default Device Settings

The default configured maintenance interval of the device is factory set to 6 months. However it is recommended that you use a shorter interval time that matches with your system maintenance schedule and/or sample workload.

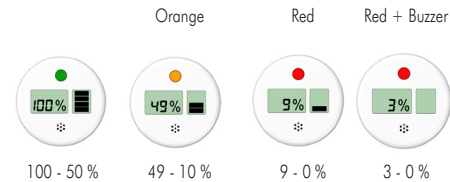

**Note:** the default notification settings can be adjusted with the configuration utility.

### 1.3 Manual Configuration

For manual configuration, download and install the latest version of the configuration software utility at [www.phenomenex.com/GasManagement](http://www.phenomenex.com/GasManagement) and connect the device to your computer with a Micro USB cable.

[www.phenomenex.com/GasManagement](http://www.phenomenex.com/GasManagement)



## 2. Installing the Device

Always ensure that the consumable or surface onto which you are mounting the device will never exceed the operating temperature limits as described in the specifications.

### 2.1 For Zebtron Gas filters with Universal ring nut

Clip the device (AG6-4130) onto the Universal Ring Nut as shown in the illustration below.

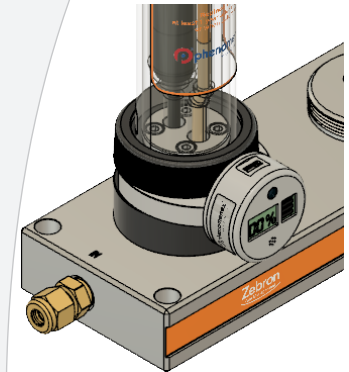

## 3. Resetting the Device

For resetting the device, download and install the latest version of the configuration software utility at [www.phenomenex.com/GasManagement](http://www.phenomenex.com/GasManagement) and connect the device to your computer with a Micro USB cable.

